



Preventive Maintenance Kit

Applicable Models: Crathco Frozen Beverage Dispenser

PM Frequency: every 6 months or as needed

Parts Included:

Springs (red and yellow) (not used on some models) (Fig B)
V-Belt (Fig C)
Hopper Float O-Ring (not used on some models) (Fig D)
Shaft Seal Set*: Stationary Seal Ring, Black Rubber Sleeve, & Spring Seal (Fig E)
Front Stator Bearing (Fig E)
Rear Stator Bearing (Fig E)
Scraper Blades (not used on some models) (Fig E)
Valve Body O-Ring (Fig F)
Barrel Gasket (Fig F)
Plunger O-Rings (Fig F)
Carb Tube O-Ring (Fig G)

Description and Instructions:

1. Turn off power to freezer and unplug.
2. **Remove side panels and vacuum or clean condenser coil (fins). See Operator Manual.**
3. Replace V-Belt. Adjust tension with set screws if necessary. See Operators Manual for more information.
4. Replace Spring. (Use same color spring as currently equipped, either red or yellow.)
5. Follow Cleaning and Maintenance process in Operator Manual to clean and sanitize freezer and all components, including replacement O-Rings, Seals, Gaskets, Bearings, and Scraper Blades. Allow all parts to dry thoroughly. Lubricate and reassemble per instructions in Operator Manual.

Fig A

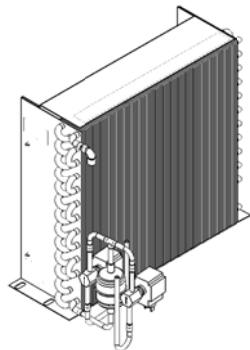

Clean coils

Fig B



Replace Spring (if equipped) with same color Spring

Fig C

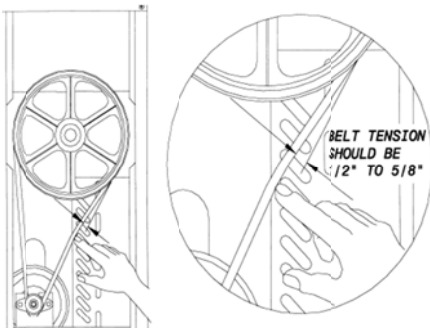

Replace V-Belt

Fig D

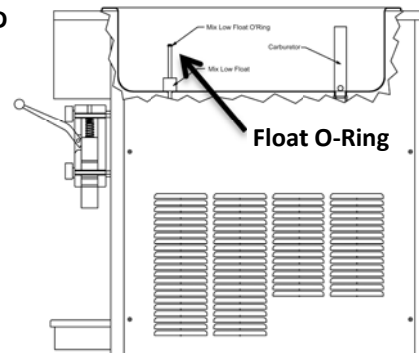

Float O-Ring

*If you are using product containing coconut oil, order Coconut Seal part # W0340210. The stationary half of the standard seal has a white polished surface. The stationary half of the coconut oil seal has a glossy black surface.

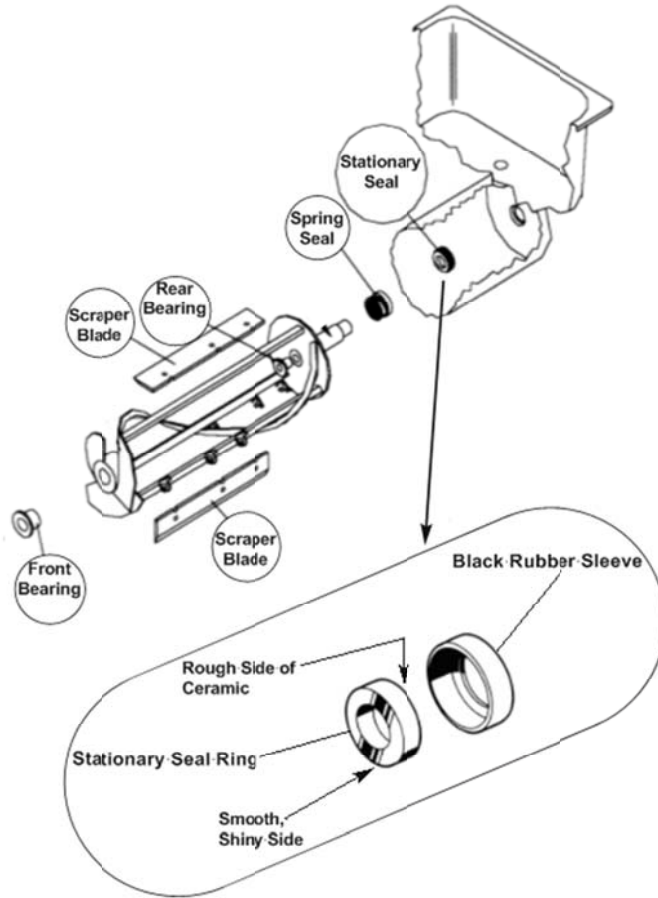
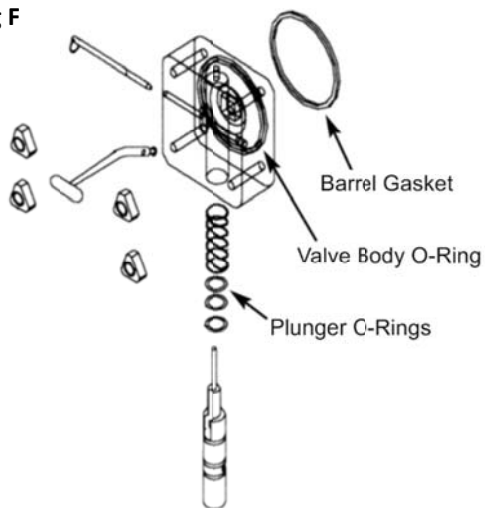
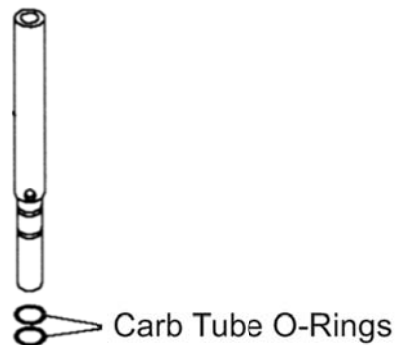
Fig E

Fig F

Fig G

Operator Manuals, including use and care instructions as well as product video tutorials, can be found on our website, www.gmcw.com. Call 1-800-695-4500 for Technical Support.