

APT18P

POUROVER COFFEE BREWER



MANUAL

- Specifications..... 2
- Installation, Start-Up, Operating Instructions 2
- Cleaning..... 3
- Adjustments & Troubleshooting..... 4
- Parts Identification..... 5
- Wiring Diagrams 7

Cecilware sells value... Worldwide

43 -05 20th Avenue, Long Island City, NY 11105

TEL • 718-932-1414

FAX • 718-932-7860



SPECIFICATIONS

MODEL	VOLTS	TOTAL KW	AMPS	W	D	H
C-2001P	120	1.6	15	8.00	17.35	17.25

WARNING: MACHINE WARRANTY IS VOID IF MACHINE IS CONNECTED TO ANY VOLTAGE OTHER THAN 120 VOLTS. (EXPORT UNITS SHOULD BE CONNECTED TO 220 VOLTS)

**** INSTALLATION INSTRUCTIONS ****

NOTE: a separate circuit should be supplied for each of these brewers with a 15 amp circuit breaker or fuse. Check local codes for compliance in installation.

MANUAL POUROVER MODELS - Are not equipped with water inlet connections.

CAUTION: DO NOT CONNECT TO POWER SOURCE UNTIL AFTER PRIMING.

These brewers are equipped with a rear Toggle Switch which controls the power to the tank heater. Toggle Switch must be in the down or "OFF" position until step (3) is completed.

**** PRIMING INSTRUCTIONS - MANUAL POUROVER UNITS ****

THESE INSTRUCTIONS ARE FOR INITIAL PRIMING ONLY AND DO NOT HAVE TO BE REPEATED FOR NORMAL OPERATION.

1. Remove sample filter pack from Brew Funnel and insert Brew Funnel back into machine.
2. Place an empty Air Pot directly under brew funnel.
3. Lift pourover cover and pour 2 liters or approximately ½ gal. (one Air Pot or one Decanter) of cold water through the top opening at 3 minute intervals. After the third Decanter is poured, water will flow through the spray head and funnel and fill the Air Pot beneath.
4. Plug line cord into receptacle and turn "ON" (TOGGLE UP) the Heater Switch, which is located in the back, then turn on the Power Switch which is located on the front panel. The Power Switch Light will light, indicating power is being applied to the machine. Wait approximately 15 minutes for the water to reach brewing temperature, at which point the green light comes on. You are ready to brew coffee.

**** BREWING INSTRUCTIONS - MANUAL POUROVER UNITS ****

After initial priming has been completed

1. Insert Brew Funnel with filter and grounds into machine.
2. Place an empty Air Pot directly under Brew Funnel.
3. Lift pourover cover and pour 2 liters or approximately ½ gal. (one Air Pot or one Decanter) of cold water through the top opening, coffee will be ready in 3 ½ minutes.
4. Remove grounds and filter as soon as coffee has dripped through. Never pour coffee back through spent grounds.

**** CLEANING INSTRUCTIONS ****

1. Wash Brew Funnel and Air Pot by hand as needed. Do not use dishwasher, which may cause Air Pot breakage.

2. For cleaning all metal surfaces, use any reputable stainless steel cleaning compound. Spray head should be checked and cleaned regularly. (At least once a week.) Spray head holes must be kept open.

To prevent “**LIMING**” problems in the water tube, remove spray head and insert spring probe all the way into the tank through the tube. When inserted into tank properly, no more than two inches of spring should be visible. Push back and forth five or six times. This will keep tubes open and clear of lime. In hard water areas, this should be done every day; this takes less than a minute.

SANITIZING:

All food dispensing units should be sanitized periodically. All parts to be sanitized must be cleaned first.

To prepare a sanitizing solution: ADD 2 TSP. OF LIQUID CLOROX BLEACH (5.25% CONCENTRATION) TO 1 GALLON OF WATER AT ROOM TEMPERATURE (70° - 90°F). Soak all parts for a minimum of 3 min. in the sanitizing solution.

Note: Always start with an unopened bottle of Clorox Bleach since the solution from an opened bottle has a short life span.

Let all sanitized parts drain and dry naturally. DO NOT WIPE THEM DRY. Before using the sanitized unit (or parts) with food stuffs, rinse all parts thoroughly with water.

CARE FOR STAINLESS STEEL: Stainless Steel surfaces that come in contact with food substances, MUST BE CLEANED EVERY DAY. WHEN CLEANING STAINLESS STEEL, ONLY A pH NEUTRAL CLEANER IS TO BE USED.

Use nylon or brass brushes (not steel wire brushes) for removing food deposit. Many food products contain acids, alkalies, or other substances which corrode Stainless Steel.

****SERVICE INSTRUCTIONS** and **TROUBLE SHOOTING GUIDE** FOR AUTHORIZED SERVICE PERSONNEL ONLY**

CAUTION: DISCONNECT POWER BEFORE ATTEMPTING ANY ELECTRICAL REPAIRS.

THERMOSTAT ADJUSTMENTS:

NOTE: The thermostat is behind the lower front panel. If water temperature is less than 197 degrees F (92 degrees C) slowly turn thermostat knob clockwise until ready light goes out. When temperature of water approaches 197 degrees to 203 degrees F (92 degrees to 95 degrees C) slowly turn thermostat knob counterclockwise until the green ready light comes on. If water temperature cannot be increased when thermostat knob is turned fully clockwise, then proceed as follows:

Pull off knob. Place a small screwdriver into the center of thermostat shaft. While observing green ready light and temperature on thermometer, hold shaft and turn small adjustment screw in center counterclockwise until green ready light goes out. When temperature of water approaches 197 degrees - 203 degrees F (92 degrees - 95 degrees C), slowly turn screw clockwise until ready light comes on. Turning screw clockwise lowers temperature; counter-clockwise raises it. After adjusting center screw, place nail polish or glyptol on screw to set in position.

NOTE: As a final check, measure water temperature at Spray Head . Temperature should be 197 degrees to 203 degrees F (92 degrees to 95 degrees C).

IF WATER FAILS TO HEAT:

1. If Red power switch does not light, check heater switch in the back, toggle should be in the up position . Check power supply outlet, replace fuse or reset circuit breaker if necessary. If power is good, check rear heater switch for continuity and replace if switch stays open.

2. If water still fails to heat, disconnect line cord and check out tank heater, thermostat and high temperature safety shutoff. Replace needed parts.

REPLACING HI-LIMIT SWITCH, THERMOSTAT, AND TANK HEATER

Unplug power cord, and remove top cover and lower front cover.

HI-LIMIT SWITCH Disconnect the (2) push-on leads, and pull out hi-limit. Replace switch.

THERMOSTAT Loosen (2) screws securing thermostat to housing. Disconnect the push-on leads and remove thermostat. Replace with new one in reverse order. When installing new control, do not overtighten small packing nut on compression fitting.

TANK HEATER Remove tank top, (4) hex nuts and washers. Disconnect push-on leads. Replace in reverse order. Remove the lower panel and loosen the (2) screws holding thermostat in place. Slide thermostat out of bracket and remove wires. Remove top cover and pull out Capillary Tank fitting from silicone grommet.

**** PARTS IDENTIFICATION ****

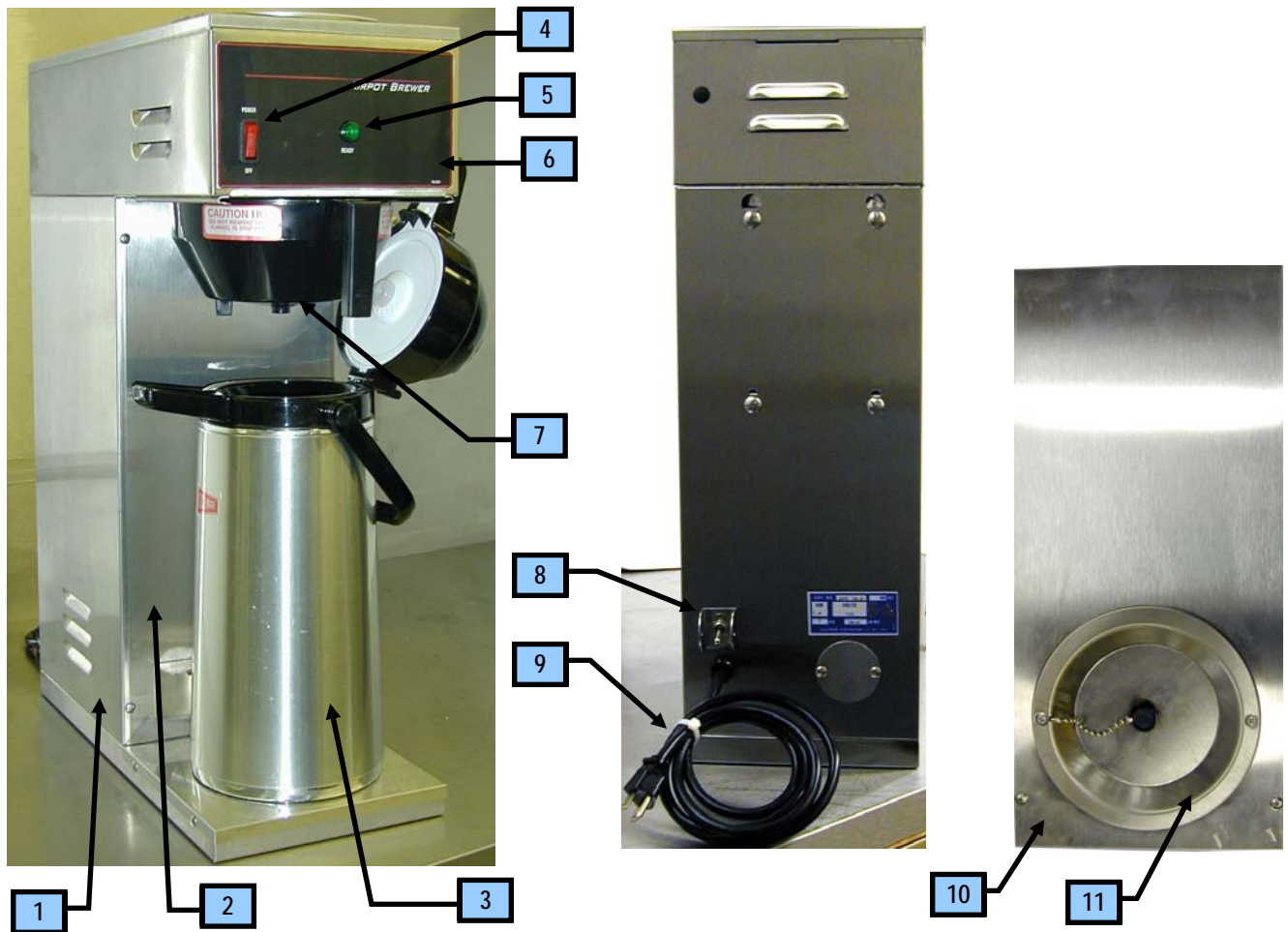

ITEM	PART NUMBER	DESCRIPTION
1	SO91Q	BODY FRAME ASSEMBLY
2	SI64A	FRONT TOWER COVER
3	V223A	AIR POT, 2.2 liters (NOT INCLUDED WITH BREWER)
4	L217A	POWER SWITCH, RED, ROCKER
5	C072A	READY LIGHT, GREEN
6	NL68A	LABEL
7	V000A	BREW FUNNEL, BLACK
8	L069A U810C	HEATER SWITCH SWITCH GUARD
9	C032A	ELECTRICAL CORD
10	U588C	COVER, POUROVER - ROUND
11	U587C	POUR OVER DISH

FRONT VIEW - OPEN

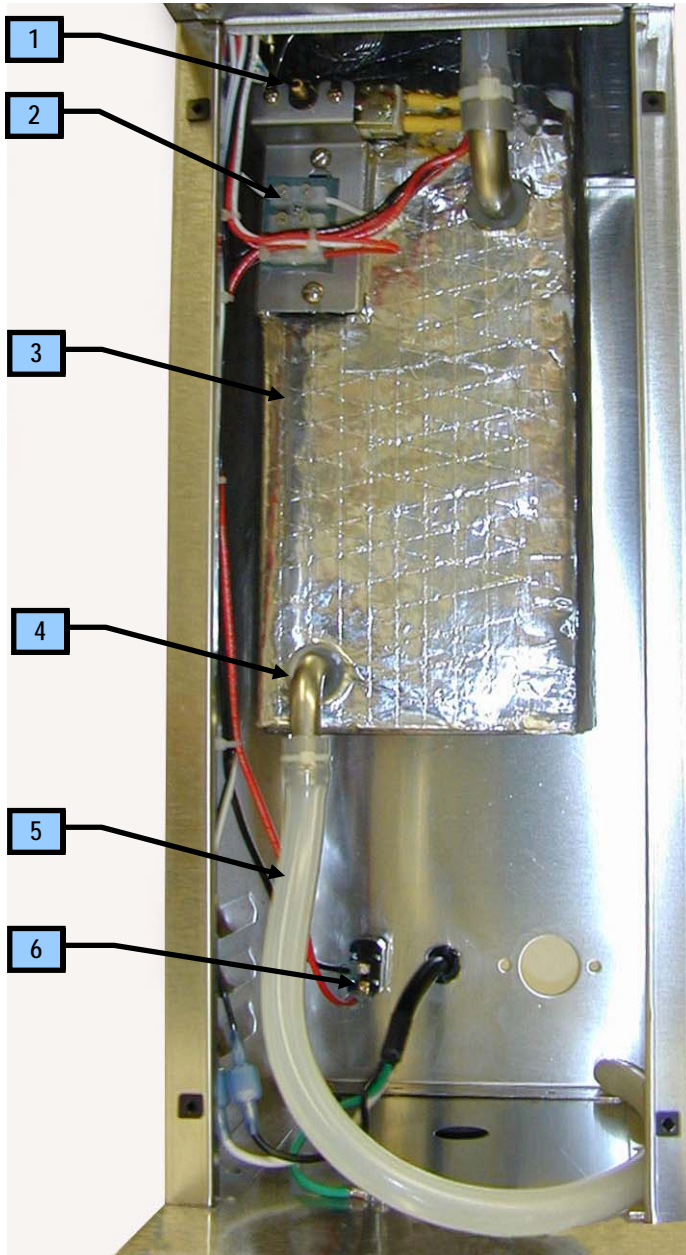

TOP VIEW - OPEN

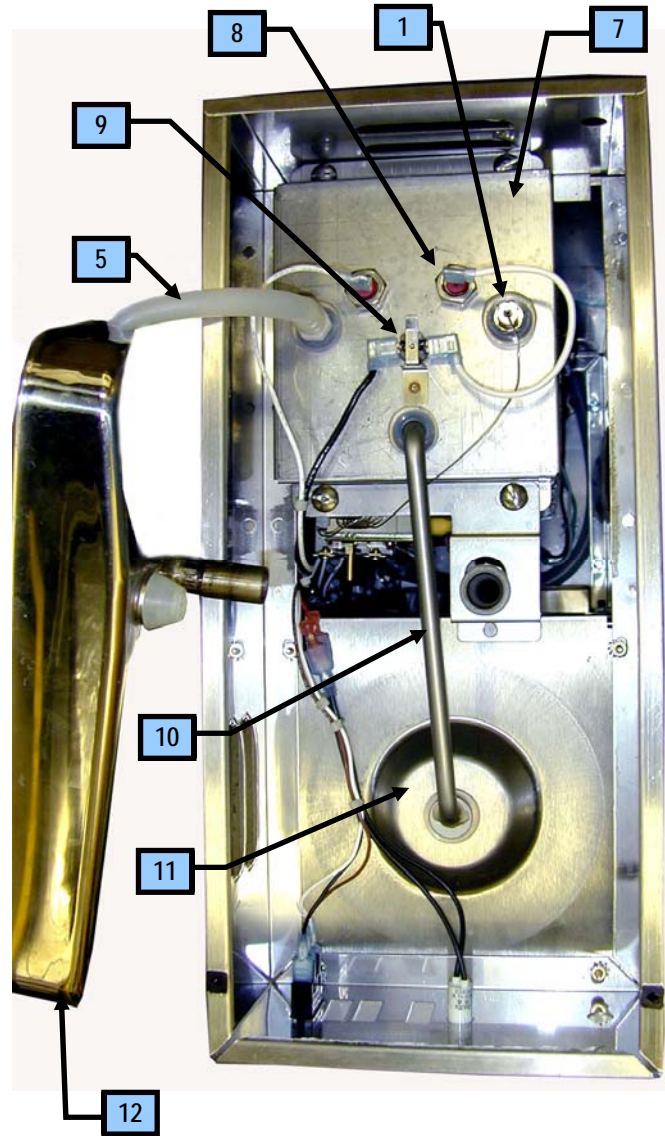

ITEM	PART NUMBER	DESCRIPTION
1	L681A	THERMOSTAT ASS'Y
2	B171A	TERMINAL BLOCK
3	RK48Q	TANK ASS'Y
4	K525A	SS ELBOW TUBE (2)
5	M611A	SILICONE TUBE, .5 ID, WATER INLET & DRAIN
6	L069A	HEATER SWITCH
7	RQ74A	TANK TOP
8	G296A	HEATER ELEMENT 120V, 1500 W
9	L573A	HI LIMIT, 220 CUTOFF
10	H297Q	SPRAY TUBE ASS'Y
11	UB28A	SPRAY HEAD HOUSING
12	RP97Q	TROUGH SUB-ASS'Y

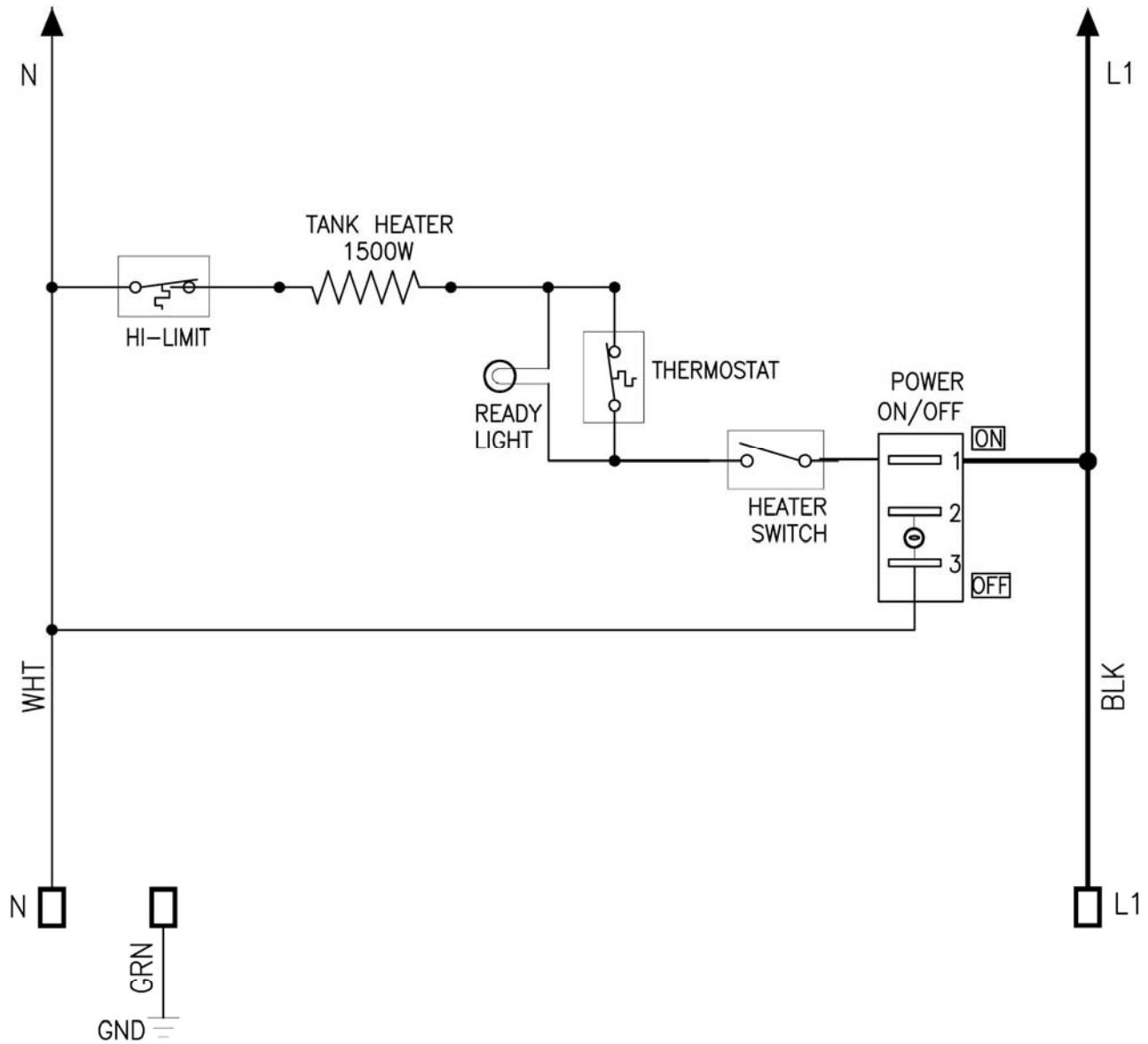

APT 18-POUROVER

			APP'D BY	DATE	PART NO NE286	NE286
REV	BY	DATE	DRAWN BY C.G.	DATE 4/5/07	SCALE 1 : 1	
CECILWARE CORPORATION 43-05 20 AVE. L.I.C. NY 11105						
TITLE: ELECTRICAL DIAGRAM, 1.5 KW, 120V, 50/60 HZ, 1 PH				APT 18-POUROVER		REV.